

KEY TO SITE DIAGRAM

Clean Water Diversions

Water from a channel can be discharged to areas of vegetation. They can be used to divert water to other sediment retention devices providing they are all located on the same site as the work.

Minimise Exposed Areas

Expose only as much ground as needed at any one time. Topsoil and regrass / revegetate exposed ground, or cover with a mulch as soon as possible.

Cover Stockpiles

Materials from trenching and excavation should be stockpiled away from low points, run off channels or kerbs and surrounded by silt fence at low points to trap material.

Maintenance and Inspections

Ensure sediment controls are regularly checked and cleaned out as required to prevent build up of sediment and failure.

Silt Fences

A silt fence is a temporary barrier of filter cloth (woven geotextile fabric) used to intercept sediment laden runoff from small areas of soil disturbance. The filter cloth is anchored to the slope firmly by burying it or using large rocks to secure it. Plastic or wire mesh or similar can be used to reinforce silt fence cloth. Shade cloth is not an acceptable filter cloth. Silt fence cloth can be purchased from major building suppliers.

On Site Works

Concrete washings, water blasting, equipment washing, concrete and tile cutting – these works can all pollute waterways unless care is taken. These products cause problems as they can be highly alkaline, or contain oxides, heavy metals or petroleum products. A wash pit bund should be constructed to capture the discharge from concrete and equipment washings.

Stabilised Entranceway

The stabilised entranceway should be the first works to occur on site, as soil transferred to the roadway by vehicles will be washed into storm water systems.

RELEVANT PROVISIONS

Amendment 6 of Proposed Plan change 11 (Minor Earthworks):

Any resource consent application involving earthworks that do not meet the permitted activity standard for earthworks shall be accompanied by an earthworks management plan/assessment. The plan/assessment should include the location and extent of proposed cuts and fills, the location in relation to any water body (if relevant), the area of vegetation to be removed, and sediment and erosion control measures to be used.

Porirua City Council Bylaw Part 24 Control of Erosion, Sediment and Silt:

24.2.1 The owner shall ensure that any development activity disturbing the soil is carried out in a way to prevent soil erosion and to stop silt and sediment from entering the stormwater system or watercourses as required under the Resource Management Act 1991 and the Building Act 2004 and their amendments.



NEED MORE INFORMATION?

Advice on the installation and use of silt and sediment control measures or full copies of the applicable rules are available from Council officers on (04) 237 5089 or via the Council's official website: www.pcc.govt.nz

SILT AND SEDIMENT CONTROL FOR SMALLER SITES

PORIRUA CITY COUNCIL BYLAW AND DISTRICT PLAN REQUIREMENTS

This guide outlines a range of measures to reduce erosion and sediment discharge to our waterways, harbour and coastal waters.

A resource consent will be required for earth works over a certain scale as set out in the Porirua City District Plan. Regardless of the size of the earthworks, you are required to put in place effective silt and sediment control measures on building and development sites.

Should appropriate protection measures not be put in place you may be served with enforcement action including an abatement notice, instant fine or reclamation of costs incurred by Council to conduct necessary work.



How to reduce erosion and sediment discharge from your site

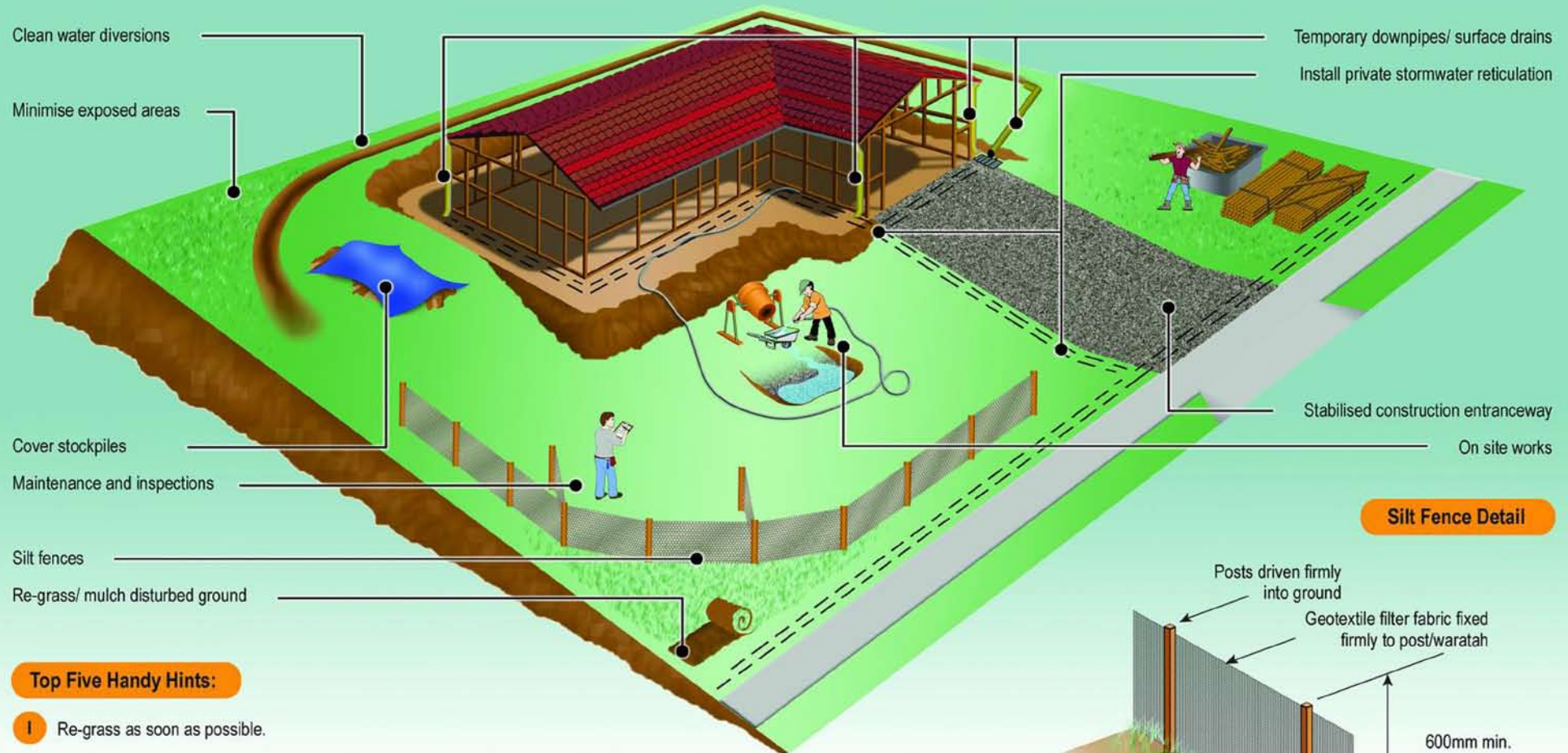

Top Five Handy Hints:

- I Re-grass as soon as possible.
- II Use proper geotextile fabric for silt fences, (do not use shade cloth).
- III Dig silt fences in 200mm and use posts at maximum 2m centres.
- IV Construct your stabilised site entrance with a geotextile base.
- V Install site stormwater drains during site preparation and discharge all clean stormwater into the stormwater pipes as soon as possible.

Silt Fence Detail

